



The Timken Company

4500 Mt Pleasant St. NW

N. Canton, OH 44720

Phone: (234) 262-3000

E-Mail: CustomerCAD@timken.com • Web site: www.timken.com

Part Number 6005-N-C3, Deep Groove Ball Bearings (6000, 6200, 6300, 6400)

Timken's deep groove ball bearings deliver reliable performance in a wide range of applications and conditions. With super-finished raceways and controlled geometries, our premium design helps ensure consistent quality.



[Specifications](#) | [Dimensions](#) | [Basic Load Ratings](#) | [Factors](#)

Specifications

Clearance	C3
Bore Size d	25.000 mm
Features	O.D. Groove
Bearing Type	Standard DGBB
Weight	0.080 Kg

Dimensions

Outside Diameter D	47.000 mm
Outside Ring Width B	12.000 mm



Radius Rs min	0.600 mm
---------------	----------

Basic Load Ratings

Cr - Dynamic Load Rating	10.1 kN
--------------------------	---------

C0r - Static Load Rating	5.8 kN
--------------------------	--------

Factors

Grease Reference Speed	14000 rpm
------------------------	-----------

Oil Reference Speed	21000 rpm
---------------------	-----------

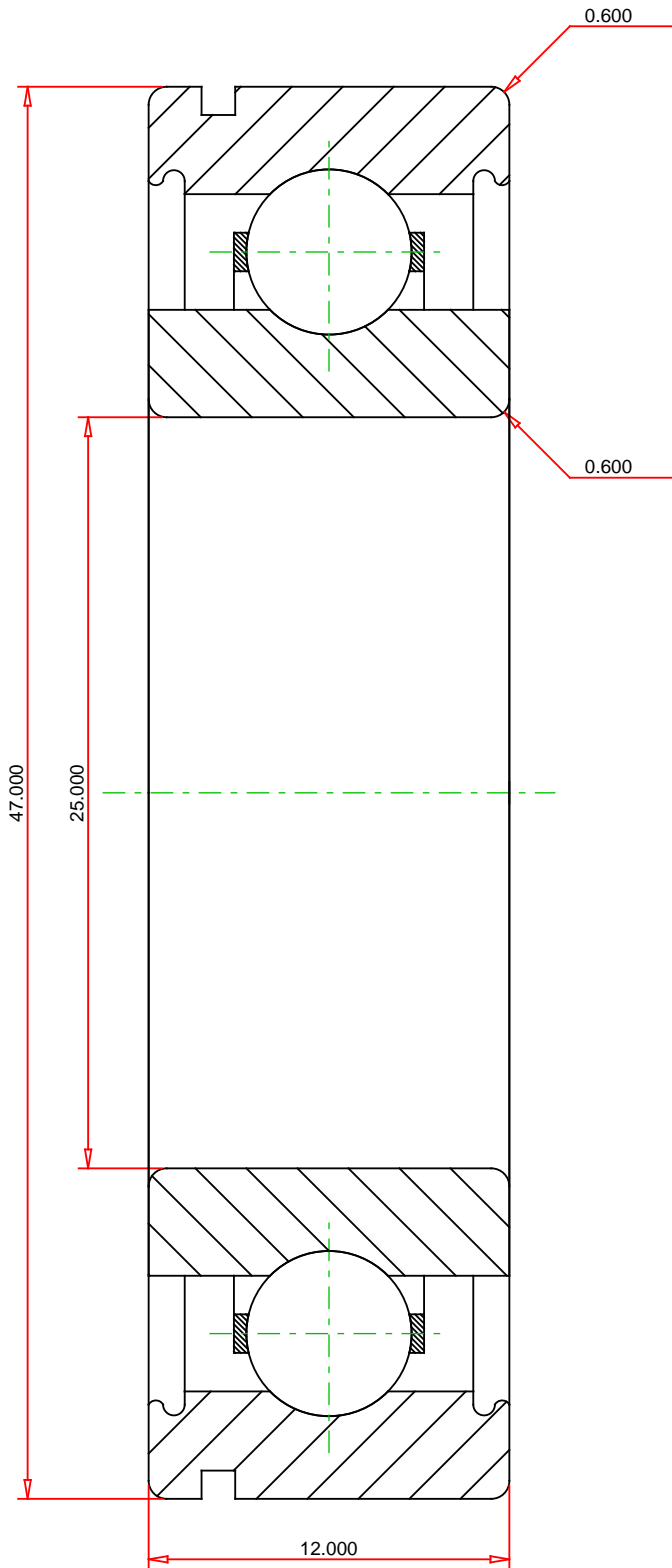

METRIC UNITS

Weight 0.08 kg

TIMKEN®

THE TIMKEN COMPANY
NORTH CANTON, OHIO USA

6005-N-C3
Deep Groove Ball Bearings (6000, 6200, 6300,
6400)

Dynamic Load Rating 10100 N
Static Load Rating 5800 N

Every reasonable effort has been made to ensure the accuracy of the information contained in this writing, but no liability is accepted for errors, omissions or for any other reason.

FOR DISCUSSION ONLY